

### ATTACHMENT COMBS

Insert the clipper blade teeth into comb and snap the comb into place. To remove combs, snap off.



### BLADE REMOVAL AND MAINTENANCE



CAUTION: Turn clipper OFF and disconnect from outlet before performing maintenance.

#### • Blade Removal

Hold clipper face up with one hand and press blade down with thumb. Remove blade into other hand to avoid dropping the blade.



#### • Blade Maintenance

Press and hold the top of the blade. Use the cleaning brush to clean hair between upper blades.

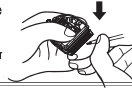

Tilt clipper head toward the floor to avoid oil seeping into motor. Use 1-2 drops of lubricating oil on the 5 points shown below.

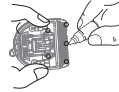

#### • Blade Installation

Hold the clipper face down with one hand and place the bottom of the blade aligning the middle of the blade with the clipper.

Push the front of the blade down until it snaps into place.

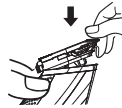

### FAILURE TO CHARGE

Make sure the outlet is working and plugs are well seated in the clipper and outlet. If clipper still fails to charge return for maintenance (see Manufacturer's 12 Month Limited Warranty).

### MAINTAINING CLIPPER BLADES

Optimal clipper operation requires oiling blades before, during, and after each use. Without proper maintenance your clipper blades will slow down or leave streaks in hair.

Oiling Clipper Blades: Ideally, clipper blades should be oiled after being detached from the clipper. When oiling clipper blades while attached to the clipper, point the blades down to prevent oil seeping into the clipper motor. Use 1 to 2 drops of clipper oil on the front and sides of the clipper blade. Wipe excess oil with a soft, dry cloth.

### LITHIUM-ION BATTERY USE, STORAGE, AND DISPOSAL

The Kenchii Flash 5 Clipper comes installed with a rechargeable lithium-ion battery. The battery does not develop a memory effect and can be recharged at any time. If the clipper will be in storage from several months or longer, store with a partial battery charge of about 40%. Store clipper in temperatures between 50°F/10°C and 104°F/40°C. Do not store in damp conditions. Do not place the clipper near heat vents, radiators, or in direct sunlight. Optimal charging requires stable temperature conditions while sudden increases in temperature will reduce battery charge capacity. Initially, new lithium-ion batteries may not fully charge, but will after several recharge cycles. When not in use for extended periods, disconnect the adapter cord from the AC outlet. Check with your municipal solid waste organizations for details on lawful disposal and recycling options.

### CLIPPER REPAIR SERVICE

Call Kenchii Customer Service at 888-453-6244 or email us at [info@kenchii.com](mailto:info@kenchii.com) for assistance resolving any issues you're experiencing with your Kenchii Flash 5 Clipper. If your issues cannot be resolved over the phone or via email we will assist you with the return for repair service process. If you wish your clipper to be serviced as well it should be carefully packed and mailed either Parcel Post Insured or U.P.S. to: Kenchii P.O. Box 440098, Kennesaw, GA 30160.

See Manufacturer's 12 Month Limited Warranty, Warranty Card, and Repair Service Instructions.

### Compatible Kenchii Flash5™ Blades & Combs



FINE/STANDARD Blades fit 5-in-1 style blade cordless clippers, such as--Kenchii Flash5™, WAHL® Arco, Bravura, Chromado, Creativa, Figura, Motion/ANDIS® Pulse Li 5, Supra Li 5.

The use of WAHL®/ANDIS® or other product names or trademarks is for informational and comparison purposes only; there is no association between KENCHII™ and these companies or their products. Wahl is a registered trademark of Wahl Clipper Corporation. ANDIS is a registered trademark of ANDIS Company.

### MANUFACTURER'S 12 MONTH LIMITED WARRANTY

Your Kenchii product is warranted against manufacturer's defects for one year from the date of purchase. If your Kenchii Flash 5 Clipper is determined to be defective in material or workmanship during the warranty period, Kenchii will repair or replace the product. Customer only pays shipping. Return the defective product along with proof of purchase, enclose a return fee of \$15.00 USD, and a note explaining the problem to: Kenchii Service, P.O. Box 440098, Kennesaw, GA 30160.

**Modifications or repairs not made by Kenchii™, accidental damage, misuse, neglect, use of unauthorized attachments or parts are not covered by this warranty.**

For customer service email [info@kenchii.com](mailto:info@kenchii.com) or call toll free 888.453.6244



© 2025 Kenchii

Kenchii Professional

P.O. Box 440098, Kennesaw, GA 30160

888.453.6244 | [info@kenchii.com](mailto:info@kenchii.com) | [Kenchii.com](http://Kenchii.com)



Model: KEFC5-WOLF



CORDLESS CLIPPER

### WARRANTY REGISTRATION CARD

Register your product within 30 days of purchase to activate its 12-month warranty. Warranty valid only when this card is completed and returned within 30 days of purchase.

Register online at [kenchii.com/warranty](http://kenchii.com/warranty) or mail in the following:  
REQUIRED WITH REGISTRATION:

1. Complete warranty card.
2. Proof of purchase. Cut out UPC from product package.
3. Copy of receipt.
4. Mail to Kenchii, P.O. Box 440098, Kennesaw, GA 30160

### IF RETURNING FOR REPAIR SERVICE:

1. Submit the Required with Registration information if not already registered.
2. Pack clipper in bubble wrap to protect during shipping.
3. Enclose a return fee of \$15.00 USD.

**REGISTER ONLINE NOW!**  
[kenchiigrooming.com/warranty](http://kenchiigrooming.com/warranty)



scan qr code with a smartphone camera or app

Salon / Customer's Name:		
Address:	Telephone:	
	Email:	
Date of Purchase (MM/DD/YY):		
Store / Distributor's Name:	City:	State:

### IMPORTANT SAFETY INFORMATION

When using an electrical appliance, basic precautions should always be followed, including the following:

**Read all instructions before using your Kenchii product.**

### DANGER: To reduce the risk of electric shock:

1. Avoid placing or storing product near water or other liquids.
2. Do not use if product, plug, or charging stand has been immersed in water or other liquid.
3. Unplug immediately if product falls into water or another emergency occurs.
4. Unplug cord from outlet and product except when charging.
5. Turn product off and unplug cord from outlet before cleaning or changing parts.

### WARNING: To reduce the risk of fire, electric shock, or personal injury:

1. Product should never be left unattended when plugged in.
2. Supervision is necessary when used by, on, or near children or individuals with certain disabilities.
3. Use this appliance only for its intended use. Do not use attachments not recommended by Kenchii.
4. Do not use this product if cord or plug is damaged, if it is not working properly, if it has been dropped, or immersed in any liquid. Return to Kenchii for repair.
5. Do not use an extension cord with this product.
6. Keep the cord away from heated surfaces.
7. Only use indoors. Do not use around aerosol products or where flammable gasses, such as oxygen, are in use.
8. To avoid injury; never use this product with a damaged or broken blade or comb.
9. To disconnect: turn control to OFF then remove plug from outlet.
10. Use only the charging stand supplied by Kenchii to recharge.
11. This product is not intended for use by children or persons with reduced physical, sensory or mental capabilities, or lack of experience and knowledge, unless they have been given supervision or instruction concerning use of the appliance by a person responsible for their safety.
12. KEEP OUT OF REACH OF CHILDREN.
13. Remove battery before disposing of product.
14. Dispose of battery properly and safely.

### OPERATING INSTRUCTIONS

Fully charge your Kenchii Flash 5 clipper for first-time use. After an initial charge the clipper can be operated cordlessly or plugged directly into an outlet. The power button toggles the clipper on and off.

Model	KEFC5-WOLF
Input	5V --- 1A 7W
Lithium Battery	3.7V 3200mAh
Charge Time	4 hours
Run Time	5 hours
Speed	5000-5500-6000-6500-7000 RPM
Noise	< 60 dB
Kit Includes	Clipper Charging Base USB Type-C Cable • 2.4m / 7.9feet. Cleaning Brush Lubricant oil Manual

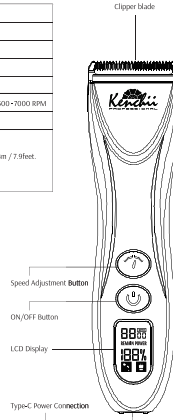

### CHANGING BLADE LENGTH

Use the Blade Length Adjustment slider on the back of the Clipper Blade to change the length of cut. Adjust the slider towards the right for a shorter cut. Adjust the slider to the left for a longer cut.

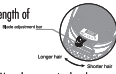

### CLIPPER LED INDICATORS

**Clipper Speed** • The Kenchii Flash 5 Clipper offers five speed settings up to 7000 RPM and as seen in the chart below. Use the Speed Adjustment button to change clipper speed.

Speed Setting	1	2	3	4	5
RPM	5000	5500	6000	6500	7000
Charging Time	Approximately 4 hours				
Run Time	Up to 5 hours				

### LCD DISPLAY



### POWER DISPLAY ON CORDLESS MODE

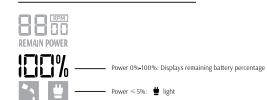

### POWER DISPLAY ON CORDED MODE

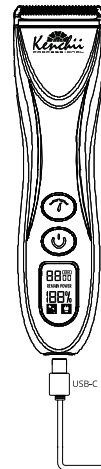
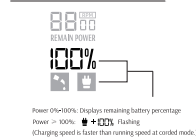

### CHARGING CLIPPER ON CHARGE BASE

The Kenchii Flash 5 Clipper can be charged using the included charging base or by connecting the clipper directly to the outlet using the adapter.

### To charge using the charge base:

1. Plug the adapter into the base or directly into the clipper.
2. Plug the adapter into a working outlet.
3. With power OFF, set the clipper into the base.

To charge the Kenchii Flash 5 Clipper without the base use either the USB cord or the power adapter provided with your clipper. The Kenchii Flash 5 Clipper can be operated while plugged in using the included cord even if the battery has been depleted.

The Kenchii Flash 5 Clipper automatically switches between 100v and 240v without a power converter.

